



**I**nnovative Design

**S**olid Construction

**T**housands of Impressions

**A**dvanced Re-Inking System

**M**ultiple Stamp Sizes

**P**recisely Engineered

**iStamp**®

Pre-Inked Stamp

**1.877.20-STAMP**

877-207-8267

[www.RubberStampCreation.com](http://www.RubberStampCreation.com)

# PREMIUM QUALITY

Finally a pre-inked stamp that can last a lifetime. istamp® Pre-inked stamps offers quality, durability, re-inkability and versatility. istamp® Pre-inked stamps offer unbeatable impression quality as well as multiple sizes to choose from. They also last over 5 times as long as any self-inking stamp before having to re-ink.

## IS-05 (F967)

copy area: 1/4" x 2-1/2"

Account # Ending with 1966

## istock (F1341)

copy area: 3/8" x 1-1/2"

**FAXED**



istock (F1341)

## IS-10 (F1743)

copy area: 9/16" x 1-1/2"

Mr. & Mrs. John Doe  
1234 Main Street  
Chicago, IL 60008

## IS-09 (F1755)

copy area: 9/16" x 2"

Rental Properties by:  
United Management Group  
[www.UnitedManagementGroup.com](http://www.UnitedManagementGroup.com)



## IS-15 (F1767)

copy area: 9/16" x 2-1/2"

[www.buypreinkedstamp.com](http://www.buypreinkedstamp.com)  
[sales@buypreinkstamp.com](mailto:sales@buypreinkstamp.com)

## IS-11 (F2255)

copy area: 11/16" x 2"

**Thank You**  
We appreciate your business

## IS-14 (F2267)

copy area: 11/16" x 2-1/2"

**PAYMENT IN FULL  
DUE UPON RECEIPT**



## IS-26 (F2291)

copy area: 11/16" x 3-3/8"

*John Doe Adams*

## IS-18 (F2767)

copy area: 15/16" x 2-1/2"

OFFICIAL SEAL  
JOHN DOE  
NOTARY PUBLIC - STATE OF ILLINOIS  
MY COMMISSION EXPIRES August 01, 2004

## IS-12 (F3255)

copy area: 1-1/8" x 2"

PAY TO THE ORDER OF  
FIRST NATIONAL BANK  
FOR DEPOSIT ONLY  
ENDORSEMENT ACCT.  
FCP COMPANY  
Acct. #1234-5678-9



## IS-21/2 (2-Color Stamp)

F3267  
(1-1/8" x 2-1/2")

1-1/8" x 9/16"

1-1/8" x 1-9/16"



**The Dove Family**  
1234 Your Street  
City, State 12345  
Phone: (123) 456-7890

## IS-23 (F3278)

copy area: 1-1/8" x 2-15/16"

**MAKE CHECK PAYABLE TO:**  
**5M Company**  
Please Reference Your Account Number  
*Thank You*

## IS-24 (F3291)

copy area: 1-1/8" x 3-3/8"

## IMPORTANT NUMBERS



Tech Support: (800) 123-4567  
Accountant: (800) 123-4568  
Maintenance: (800) 123-4569  
West Branch: (800) 123-4560

## IS-72 (F32103)

copy area: 1-1/8" x 3-7/8"

**See Attached Copy of:**

Employee Agreement	<input type="checkbox"/>
Non-Employee Agreement	<input type="checkbox"/>
Non-Compete Agreement	<input type="checkbox"/>

# CRISP AND CLEAN IMPRESSIONS

**IS-44** (F4355)  
copy area: 1-9/16" x 2"

**PAID IN FULL**

All returns must be accompanied with a receipt. Only store credit will be issued.



**IS-16** (F4367)  
copy area: 1-9/16" x 2-1/2"

**HAZARDOUS MATERIAL**  
**KEEP AWAY FROM HEAT & DIRECT SUNLIGHT**  
**HANDLE WITH CARE**

**IS-25** (F4378)  
copy area: 1-9/16" x 3"

**BIKERS PARADISE**



[www.bikersparadise.com](http://www.bikersparadise.com)

WE OFFER:

- \* New Bikes
- \* Used Bikes
- \* Apparel
- \* Bike Racks
- \* Tools
- \* Accessories
- \* Tune Ups
- \* Repair
- \* and more

**IS-27** (F43103)  
copy area: 1-9/16" x 3-7/8"

Customer to supply press ready electronic art and a hard copy print of the file.

Preferred file formats for electronic art are:

1. Adobe Acrobat PDF
2. Adobe Illustrator EPS
3. Other PDF formats (may involve additional costs)

Files in other formats may be usable. Additional costs may apply.

**IS-75** (F43130)  
copy area: 1-9/16" x 4-3/4"

Purchase Order Number: \_\_\_\_\_ Date: \_\_\_\_\_

Account Number: \_\_\_\_\_

Contact Name: \_\_\_\_\_

Company Name: \_\_\_\_\_

**IS-63** (F53103)  
copy area: 1-15/16" x 3-7/8"

**VOTE**

Yes  No

**IS-60** (F5391)  
copy area: 1-15/16" x 3-7/16"

**FRAGILE**

**DO NOT USE BOX KNIFE!**  
**DO NOT DROP!**

**IS-22** (F5378)  
copy area: 1-15/16" x 2-15/16"

**RETURN POLICY**

**15%** Re-stocking charge applies to *un-opened box*

**30%** Re-stocking charge applies to *opened box*

ALL RETURNS MUST BE ACCOMPANIED WITH A RECEIPT.

**IS-55** (F5355)  
copy area: 2" x 2-1/16"



Expires: February 27 2012

**IS-28** (F66103)  
copy area: 2-3/8" x 3-7/8"

**PLEASE!**  
Help Us Update our File

Company Name: \_\_\_\_\_  
 Contact Name: \_\_\_\_\_  
 Address: \_\_\_\_\_  
 \_\_\_\_\_  
 Phone: \_\_\_\_\_ Fax: \_\_\_\_\_  
 Email: \_\_\_\_\_

**IS-66** (F6685)  
copy area: 2-3/8" x 3-1/8"

**CHECKED BY:**

Inspector 001 \_\_\_\_\_  
 Inspector 002 \_\_\_\_\_  
 Inspector 003 \_\_\_\_\_  
 Inspector 004 \_\_\_\_\_  
 Inspector 005 \_\_\_\_\_

**IS-70** (F78103)  
copy area: 2-7/8" x 3-7/8"

**Buy One  
Get One Free**

*Creative*

**Flower Shop & Boutique**  
 6007 Elk Road  
 Chicago, IL 60666  
 expires: April 1st 2005

**IS-30** (F13)  
copy area: 7/16" Round



**IS-32** (F19)  
copy area: 5/8" Round



**IS-34** (F23)  
copy area: 3/4" Round



**IS-49** (F35)  
copy area: 1-1/4" Round

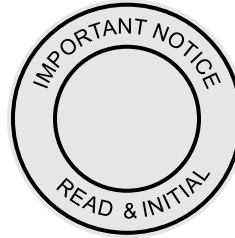

**IS-53** (F51)  
copy area: 1-3/4" Round



**IS-80** (F94130)  
copy area: 3-3/8" x 4-3/4"

Invoice Number: \_\_\_\_\_ Date: \_\_\_\_\_  
 Account Number: \_\_\_\_\_  
 Contact Name: \_\_\_\_\_  
 Company Name: \_\_\_\_\_  
 Address: \_\_\_\_\_  
 \_\_\_\_\_  
 City: \_\_\_\_\_ State: \_\_\_\_\_  
 Phone: \_\_\_\_\_ Fax: \_\_\_\_\_  
 Email: \_\_\_\_\_  
 Website: \_\_\_\_\_

**Re-inking Instructions**

Use istamp ink only.

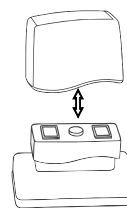

**1** Remove handle by holding the bottom base and pulling off the handle.

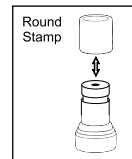

**3** Replace the handle. Stamp is ready for use after 30 minutes. Repeat procedure if necessary.



**2** Add 10 drops through each ink port. Add 20 drops for sizes that have a printing area of 6 square inches or larger. Note: Use istamp™ ink only.

